

Hyatt Regency St. Louis at The Arch

ADDRESS 315 Chestnut Street, St. Louis, MO 63102, USA
PHONE 314 655 1234 FAX 314 241 9839
WEB stlouisarch.hyatt.com



ACCOMMODATIONS

- 910 guestrooms, including 60 suites

All accommodations offer:

- Spectacular Gateway Arch or Downtown view rooms
- Wireless and wired high-speed Internet access
- 37-inch flat-screen television with remote control, in-room pay movies
- Telephone with voice mail and data port
- Deluxe bath amenities
- Hair dryer
- Iron / ironing board
- iHome® alarm clock radio

SERVICES & FACILITIES

- 1-800-CHECK-IN®
- Video checkout
- Hyatt Fast Board™
- Complimentary wireless Internet access in public areas
- In-room dining
- Business center
- Concierge services
- Laundry / dry cleaning
- Gift shop
- Enterprise Rent-A-Car

RESTAURANTS & BARS

- Red Kitchen and Bar—three meal restaurant and lobby lounge
- Starbucks®—full service coffee shop
- Brewhouse Historical Sports Bar—bar and grill
- Ruth's Chris Steak House—fine dining

CONFERENCES & BANQUETS

- Grand Ballroom offers 20,000 square feet of space with 14,600 square feet of prefunction space
- Regency Ballroom offers 16,800 square feet of space with 8,725 square feet of prefunction space
- The intimate Park View room offers 3,300 square feet of unique space with beautiful arched windows, and a view of the Gateway Arch
- Gateway East, West, and Terrace located on the 18th floor features nearly 7,000 square feet of meeting space and outdoor space with spectacular Arch views
- 18 conference rooms that offer the utmost in style and flexibility

RECREATIONAL FACILITIES

- 24-hour Hyatt Stay Fit gym

POINTS OF INTEREST

- America's Center®
- Anheuser-Busch Brewery Tour
- Busch Stadium (Cardinals)
- Basilica of St. Louis (Old Cathedral)
- Cathedral Basilica (New Cathedral)
- City Garden
- City Museum
- Contemporary Art Museum
- Edward Jones Dome (Rams)
- The Fabulous Fox Theatre
- Forest Park
- Gateway Arch Riverboats
- Gateway Arch
- Gateway International Raceway
- Grant's Farm
- Jefferson National Expansion Memorial
- Laclede's Landing
- Lumiere Place Casino
- The Magic House (a St. Louis Children's Museum)
- Missouri Botanical Garden
- Missouri History Museum
- The Muny (seasonal outdoor amphitheater)
- Museum of Transportation
- Old Courthouse
- Opera Theatre of St. Louis
- The Pageant in the Loop
- Repertory Theatre of St. Louis
- Scottrade® Center (Blues)
- Soldiers Memorial Military Museum
- Soulard Farmers Market
- Stages St. Louis (music theater)
- St. Louis Art Museum
- St. Louis Executive Conference Center
- St. Louis Science Center
- St. Louis Symphony Orchestra
- St. Louis Zoo
- University City Loop

Hyatt Regency St. Louis at The Arch

ROOM DIMENSIONS & CAPACITIES



Room name

Room name	Room Dimensions Length x Width x Height	Square Feet	Banquet	Reception	Theater	Classroom	Boardroom	U-Shape	Hollow Square	Exhibit 8' x 10'
SECOND FLOOR										
PREFUNCTION	—	8,725	—	1,160	—	—	—	—	—	37
REGENCY BALLROOM	200' x 84' x 16'	16,800	1,160	1,865	1,565	1,020	—	—	—	—
ABCD OR CDEF	150' x 84' x 16'	12,600	870	1,440	1,400	764	—	—	—	—
ABC OR DEF OR CD	100' x 84' x 16'	8,400	580	935	935	508	—	—	—	—
AB OR C OR D OR EF	50' x 84' x 16'	4,200	290	470	470	256	—	—	—	—
A OR B OR E OR F	50' x 42' x 16'	2,100	150	240	240	128	—	44	—	—
STERLING STUDIO 1	26' x 21' x 10'	546	40	55	55	30	20	17	20	—
STERLING STUDIO 2	26' x 17' x 10'	442	40	50	50	25	20	17	20	—
STERLING STUDIO 3	26' x 30' x 10'	780	50	85	85	43	24	24	28	—
STERLING STUDIO 4	26' x 16' x 10'	416	40	50	50	25	20	17	20	—
STERLING STUDIO 5	25' x 17' x 10'	425	40	50	50	25	20	17	20	—
STERLING STUDIO 6	25' x 25' x 10'	619	50	60	60	35	24	22	28	—
STERLING STUDIO 7	25' x 18' x 10'	450	40	50	50	25	20	17	20	—
STERLING STUDIO 8	26' x 18' x 10'	468	40	55	55	25	20	17	20	—
STERLING STUDIO 9	26' x 41' x 10'	1,066	80	115	115	58	20	16	20	—
FOURTH FLOOR										
PREFUNCTION	—	14,600	—	1,600	—	—	—	—	—	31
GRAND BALLROOM	178' x 111' x 18'	19,758	1,370	2,200	2,200	1,196	—	—	—	—
ABCDE OR DEFGH	136' x 111' x 18'	15,096	1,050	1,680	1,680	912	—	—	—	—
ABCD, EFGH	89' x 111' x 18'	9,879	700	1,100	1,100	600	—	—	—	—
DE	94' x 111' x 18'	10,434	720	1,160	1,160	632	—	—	—	—
ABC OR FGH	42' x 111' x 18'	4,662	320	520	520	284	—	—	—	—
D OR E	47' x 111' x 18'	5,217	360	580	580	316	—	—	—	—
A, B, C, F, G OR H	42' x 37' x 18'	1,554	110	175	175	96	32	30	40	—
AB, BC, FG OR GH	42' x 74' x 18'	3,108	220	350	350	188	—	—	—	—
MILLS STUDIO 1	26' x 21' x 8'	546	40	55	55	30	20	17	20	—
MILLS STUDIO 2	26' x 17' x 8'	442	40	50	50	25	20	17	20	—
MILLS STUDIO 3	26' x 30' x 8'	780	60	85	85	43	24	24	28	—
MILLS STUDIO 4	26' x 16' x 8'	416	40	50	50	25	20	17	20	—
MILLS STUDIO 5	26' x 17' x 8'	425	40	50	50	25	20	17	20	—
MILLS STUDIO 6	25' x 25' x 8'	619	50	70	70	35	24	22	28	—
MILLS STUDIO 7	25' x 18' x 8'	450	40	50	50	25	20	17	20	—
MILLS STUDIO 8	26' x 18' x 8'	468	40	55	55	30	20	17	20	—
MILLS STUDIO 9	—	498	40	—	—	—	14	—	—	—
PARK VIEW	66' x 50' x 12'	3,300	230	370	300	200	30	30	36	17
EIGHTEENTH FLOOR										
GATEWAY WEST	38' x 44' x 12'	1,672	120	185	185	100	50	35	45	—
GATEWAY EAST	50' x 44' x 12'	2,200	150	245	245	130	55	40	50	—
GATEWAY TERRACE	53' x 56'	2,968	190	300	—	—	—	—	—	—



Hyatt Regency St. Louis at The Arch

DIRECTIONS

By car from Lambert Field International Airport (15 miles): Take I-70 East to Memorial Drive exit. Go straight on Memorial Drive. Turn right onto Market Street. Turn right onto North 4th Street. Turn right onto Chestnut Street – hotel on left.

SECOND FLOOR

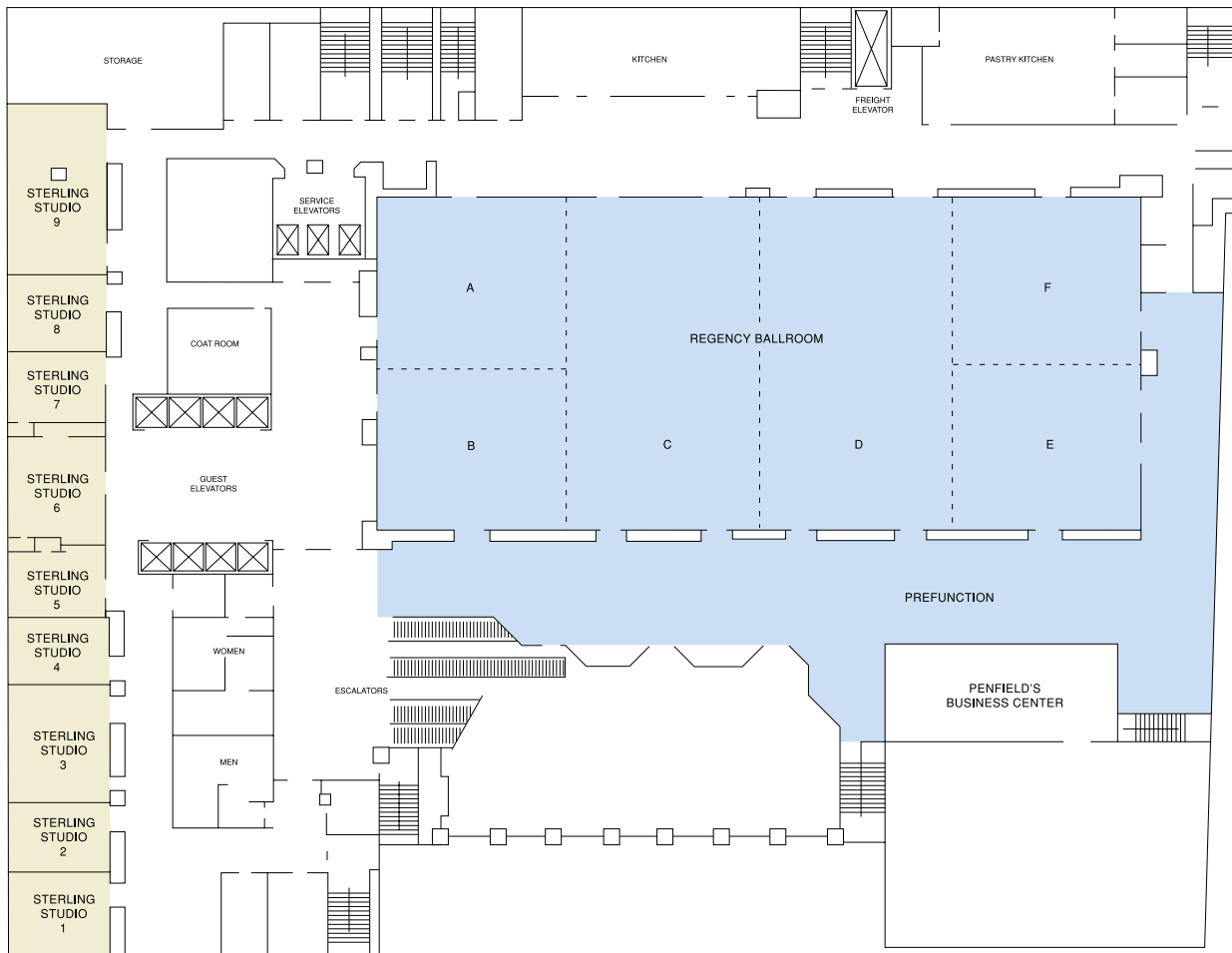

Hyatt Regency St. Louis at The Arch

FLOORPLAN

FOURTH FLOOR

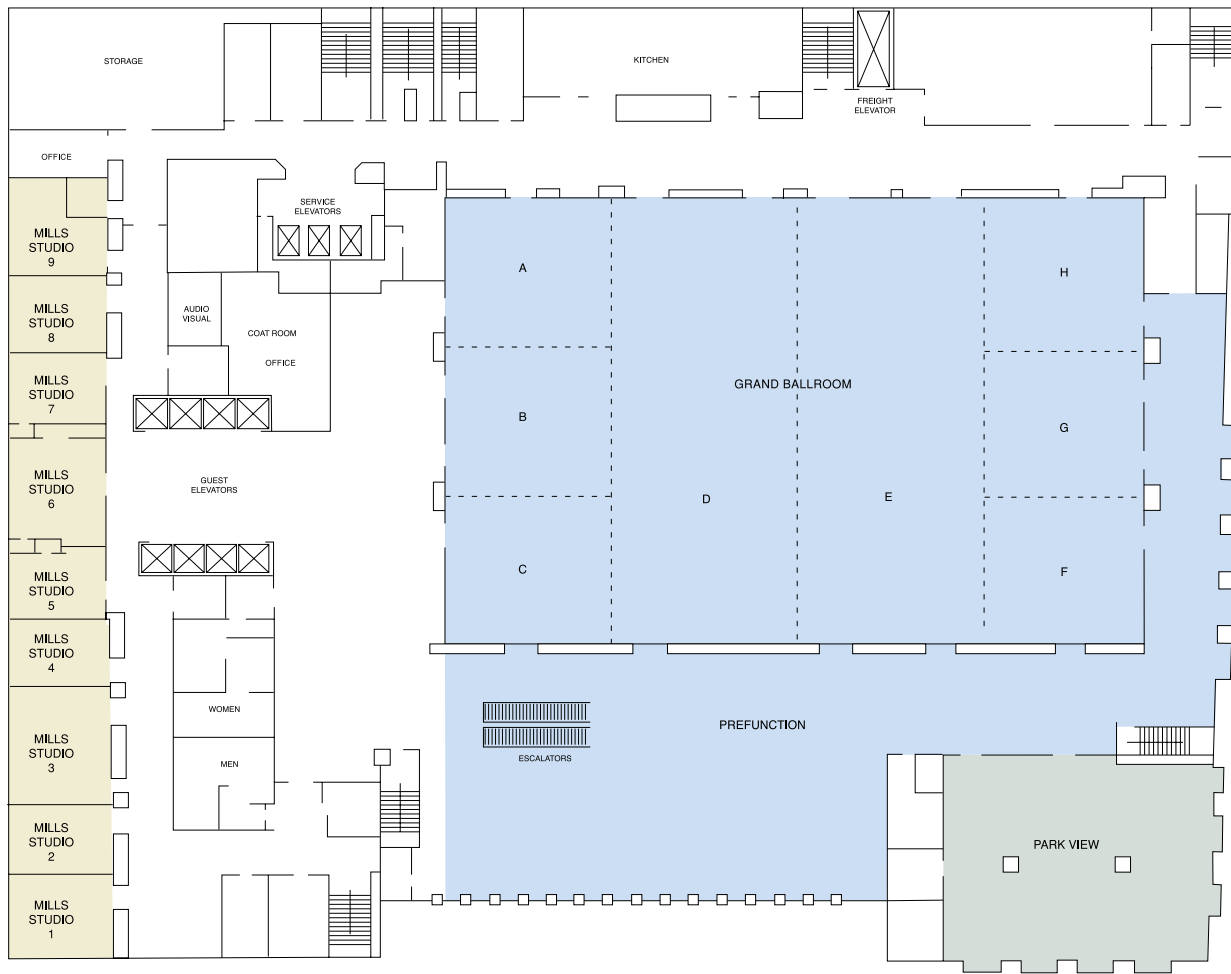

ST. LOUIS ARCH ►

Hyatt Regency St. Louis at The Arch

FLOORPLAN

EIGHTEENTH FLOOR

ST. LOUIS ARCH ►

